

MAINTENANCE INSTRUCTIONS

Augusta EVO Landing Doors

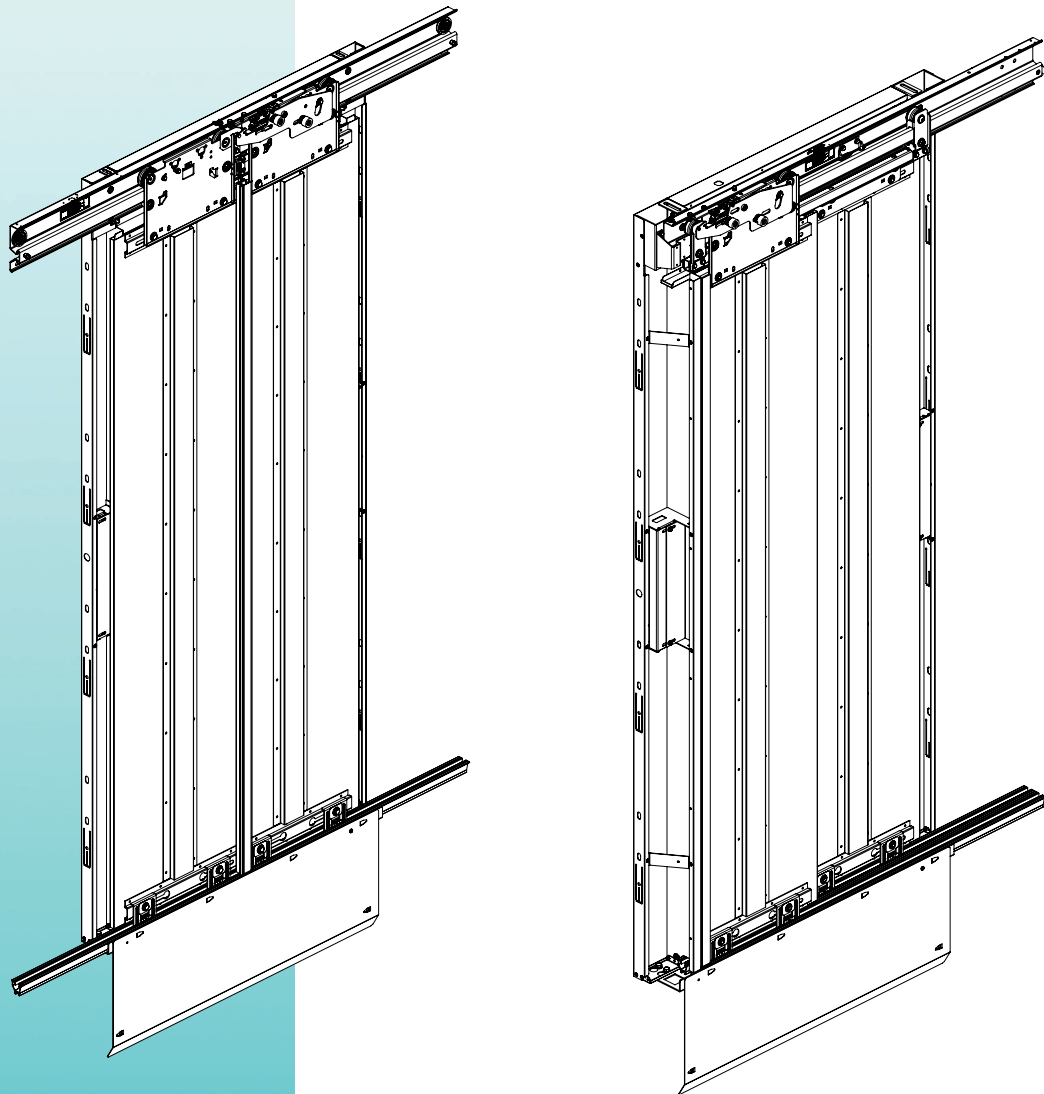

No part of this publication may be reproduced or translated, even in part, without prior written permission from WITTUR.

© Copyright WITTUR 2014

Subject to change without notice!

URL: <http://www.wittur.com>
e-mail: info@wittur.com



INDEX

Foreword	Pag. 2
Symbols used	Pag. 2
Warnings	Pag. 3
Suggestions	Pag. 3
1. Preventive Maintenance	Pag. 4
1.1. Overview	Pag. 4
2. Re-Closing device	Pag. 6
2.1. Type C2	Pag. 6
2.2. Type T2	Pag. 7
2.3. Adjustment of counter rollers	Pag. 8
3. Lock	Pag. 9
4. Adjustment of the lock rollers	Pag. 11
4.1. Position of the coupler between the landing lock rollers	Pag. 12
5. Adjustment of door panel running clearance	Pag. 13
6. Alignment of door panels	Pag. 14
7. Transmission cable	Pag. 15
8. Check door unlocking device	Pag. 16
9. Lubrication	Pag. 17
10. Mechanical strength	Pag. 18
11. Replacement	Pag. 19
11.1. Door Panel	Pag. 19
11.2. Main rollers	Pag. 20
11.3. Counter rollers	Pag. 21
11.4. Door buffer rubber	Pag. 22
11.5. Rubber limit lock	Pag. 23
11.6. Replace lock rollers	Pag. 24
11.7. Guide shoes (Check - Replace)	Pag. 25
Warnings on how to keep the doors in good operating conditions	Pag. 27

Congratulations on choosing a **WITTUR** product!

Before starting the installation of this product, read the information contained in this document.

You will find important warnings on how to assemble and maintain your **WITTUR** product in good operating conditions and to get the maximum of your investment.

You will also find important information concerning the product care and maintenance which are an important factor to ensure safety at all times.

WITTUR has long been involved in research aimed at reducing noise level and in design that takes into due consideration the product quality and the conservation of environment.

 This document is an integral part of the supply and must be available in the lift power room at all times.

All products are provided with identification type label and in case with certification marks in accordance with the current rules.

In case of need concerning the product, the identification data on the label must be always communicated to us.

We hope you will get full satisfaction from this **WITTUR** product. Yours faithfully.

WITTUR

The points that are important under the safety viewpoint and danger warnings are indicated with these symbols:

 Danger general

 Important warnings

 Risk of personal injury (e.g. sharp edges, protruding parts)

 Risk of damage to mechanical parts (e.g. incorrect installation)

 Live parts

WARNINGS

- WITTUR will not be held liable for any damage caused by tampering of the packing material by thirds.
- Before starting assembly, check that the product received corresponds to the order and to the packing list and that no damage has occurred in transit.
- Within its policy of continual research, WITTUR reserves to make changes to its products without notice. The figures, descriptions and data contained in this manual are intended as purely indicative and not binding.



- To ensure the safety of the product, avoid any alteration or tampering.
- WITTUR liability will be limited to the original components only.
- WITTUR product is intended for use in the lift sector only, therefore WITTUR liability shall be limited to such use.



- This product is intended for professional use. Any improper use, including for hobby or DIY, is prohibited.
- In order to prevent any injury to persons and damage to property, the handling, installation, adjustment and maintenance must be carried out by suitably trained personnel, using appropriate clothing and equipment.
- Any masonry work connected with the correct installation of the product must be executed in a workmanlike manner according to the applicable laws.
- The connection of the electric/electronic units to the local power supply must be executed in a workmanlike manner according to the applicable laws.



- All metal parts supporting the electric/electronic units must be connected to an earth system in a workmanlike manner according to the applicable laws.
- Before connecting the product to the power supply check that the product's requirement

- WITTUR shall have no responsibility on the execution of masonry works or the connection of electric/electronic components to the power supply.



- WITTUR shall not be liable for damages/injury to property/persons caused by improper use of the emergency opening devices.

SUGGESTIONS

- Keep the material in the original packing, protected from bad weather and direct exposure to sun during the storage period in order to avoid the accumulation of water/condensation inside the packing material.
- Never dispose of packing material in the environment.
- Once dismantled, the product should be conveniently disposed as provided for by the local laws; never dispose of in the environment.
- Whenever possible, re-cycling is preferable to disposal in dump sites.
- Before re-cycling check the nature of the various materials and re-cycle in the appropriate way.

1. PREVENTIVE MAINTENANCE

1.1. Overview

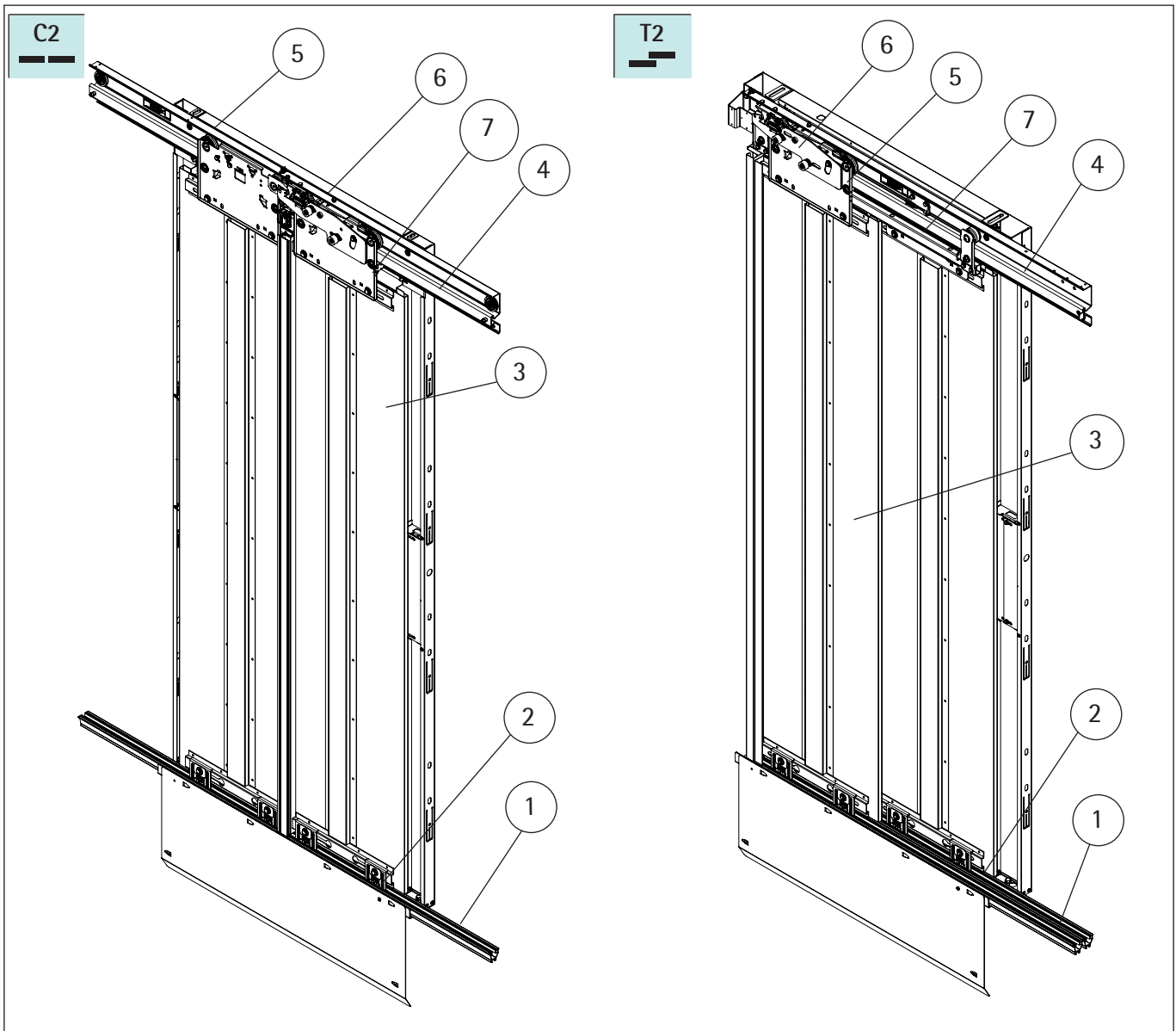

Note: M = Months

Landing Door Miscellaneous

Interval	Pos. No	Description	Details Given In
12 M	-	Check for damages	Section 1.1
12 M	-	Check for corrosion	
12 M	-	Clean and dry mechanism	
12 M	4	Clean main tracks, no oiling	Section 1.1
12 M	1	Clean landing sills	
12 M	1	Check sill gap	

Subject to change without notice!



Landing Door Miscellaneous

Interval	Pos. No	Description	Details Given In
12 M	3	Check vertical parallelism of door panels	Section 5; 6
12 M	3	Check alignment of door panels	
12 M	-	Check gaps between door panels and frames	
12 M	-	Check gaps between door panels and door sill	
12 M	-	Check if no tilt of panels	
12 M	-	Check easy and smooth running of door panels	
12 M	5	Check main rollers, counter rollers and retaining washers	Section 2.1; 2.2; 2.3; 11.7
12 M	2	Check guiding shoes	
12 M	7	Check if the door re-closes automatically	

Landing Door Specials

Interval	Pos. No	Description	Details Given In
12 M	-	Check adjustment of landing door interlock	Section 4.1
12 M	-	Check door unlocking device	Section 8

Landing Door Miscellaneous

Interval	Pos. No	Description	Details Given In
12 M	6	Check of penetration of hook lock and lock engage	Section 3; 8
12 M	6	Check the unlocking device activity	
12 M	6	Correct function and bearing play of lock roller and lock bearing	
12 M	6	Condition of contact bridge	
12 M	6	Condition of safety contacts	
12 M	6	Check lock roller	
12 M	6	Check safety contact (KTS, KNET...)	
12 M	6	Check contact bridge	

Replacement to be done based on condition

2. RE-CLOSING DEVICE

2.1. Type C2



Step	Action	Note
1	The door will close from 0 to 10 cm from its center.	Open the door for 10 cm, the re-closing spring must close it.
2	Check that the counter rollers rotate freely (finger-tight) against the rail profile. If needed, loosen the nut and adjust the eccentric roller using a hexagon key (see pag.8).	
3	Check that the wire ropes are not worn out.	

2.2. Type T2



Step	Action	Note
1	The door will close from 0 to 10 cm from the strike jamb.	Open the door for 10 cm, the re-closing spring must close it.
2	Check that the counter rollers rotate freely (finger-tight) against the rail profile. If needed, loosen the nut and adjust the eccentric roller using a hexagon key (see pag.8).	
3	Check that the wire ropes are not worn out.	

2.3. Adjustment of counter rollers

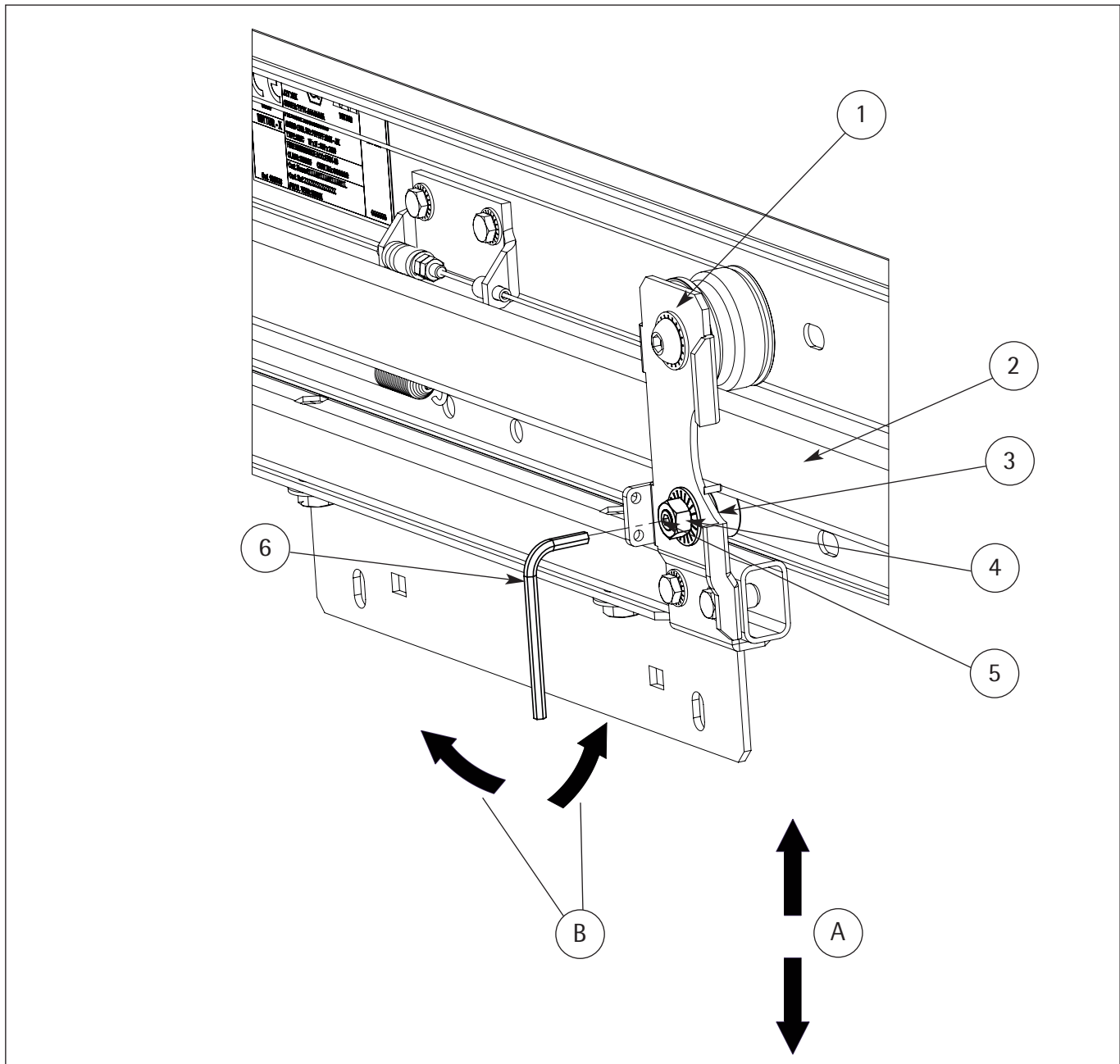

Step	Action	Note
1	Loosen the bolt (4) with a 15 mm spanner and turn the eccentric bolt (5) clockwise or counter clockwise, as indicated by the arrows (B) with a 4 mm allen-key (6) so as to get rid of the play (A) between the guide and roller but leaving enough play to allow the roller to rotate freely. After this adjustment, tighten the fixing bolt (4).	To reduce the play between the truck (1) and the sliding guide (2) to the right amount, adjust the counter roller (3) on the bottom. The counter roller (3) has to contact the sliding guide (2) and turn freely with the finger.

3. LOCK

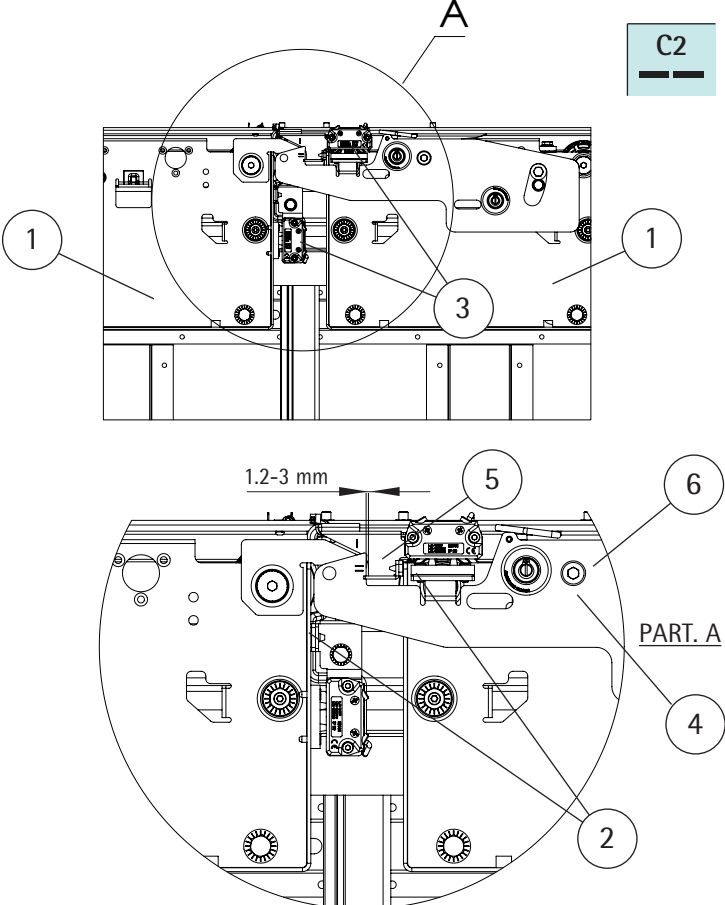
Step	Action	Note
1	<p>Close the door fully so that the hangers (1) are against the buffers (2) and check the lock function.</p> <ul style="list-style-type: none"> - The lock play should be 1.2-3 mm (not adjustable). - Ensure the lock play does not break the door contact (3) function. - The hook lock (4) must be 7 mm engaged to the counter lock (5) before to close the contact (3) with the bridge. 	<p>Hangers in closed position.</p>  <p>The trucks (1) must touch the rubbers (2) when the doors is closed.</p>



In case of not right function of the lock the full truck (1) has to be replaced. Due to safety reasons it is not allowed to untight the lock fixing bolt (6).

Step	Action	Note
1	<p>Close the door fully so that the hangers (1) are against the buffers (2) and check the lock function.</p> <ul style="list-style-type: none"> - The lock play should be 1.2-3 mm (not adjustable). - Ensure the lock play does not break the door contact (3) function. - The hook lock (4) must be 7 mm engaged to the counter lock (5) before to close the contact (3) with the bridge. 	<p>Hangers in closed position.</p> <p>The trucks (1) must touch the rubbers (2) when the doors is closed.</p>



In case of not right function of the lock the full truck (1) has to be replaced. Due to safety reasons it is not allowed to untight the lock fixing bolt (6).

4. ADJUSTMENT OF THE LOCK ROLLERS

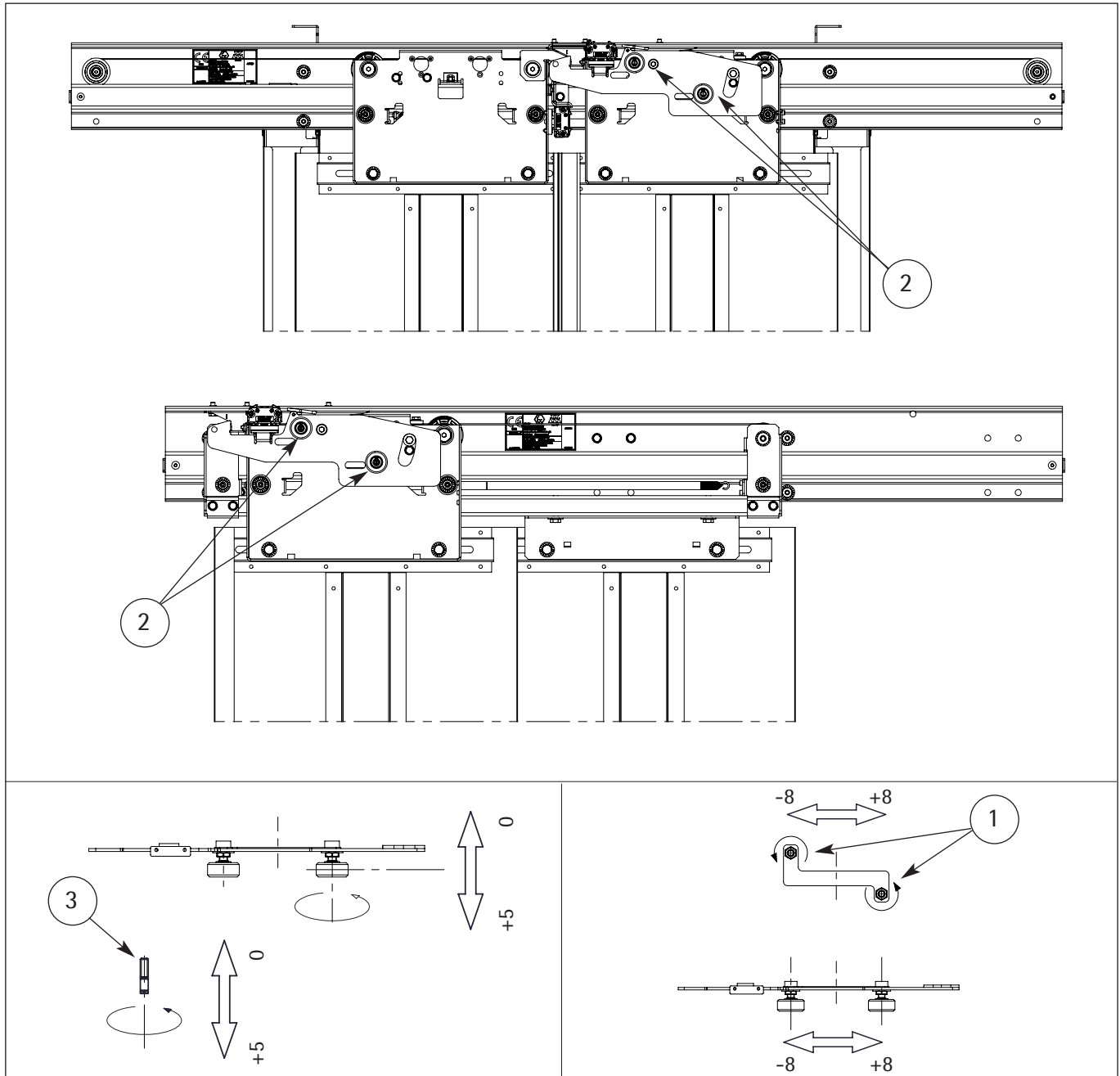

Step	Action	Note
1	With a 5 mm allen-key, loosen screws (1) and set the alignment of the lock rollers (2), starting from the lowest level, as the car is operated upwards. Using a CH 13 spanner, loosen screws (3) and set the roller position with screw driver (see 4.1).	Move the lock rollers unit and position it as shown. Make sure that between the lock rollers and the car sill there is sufficient clearance to provide runby.

4.1. Position of the coupler between the landing lock rollers

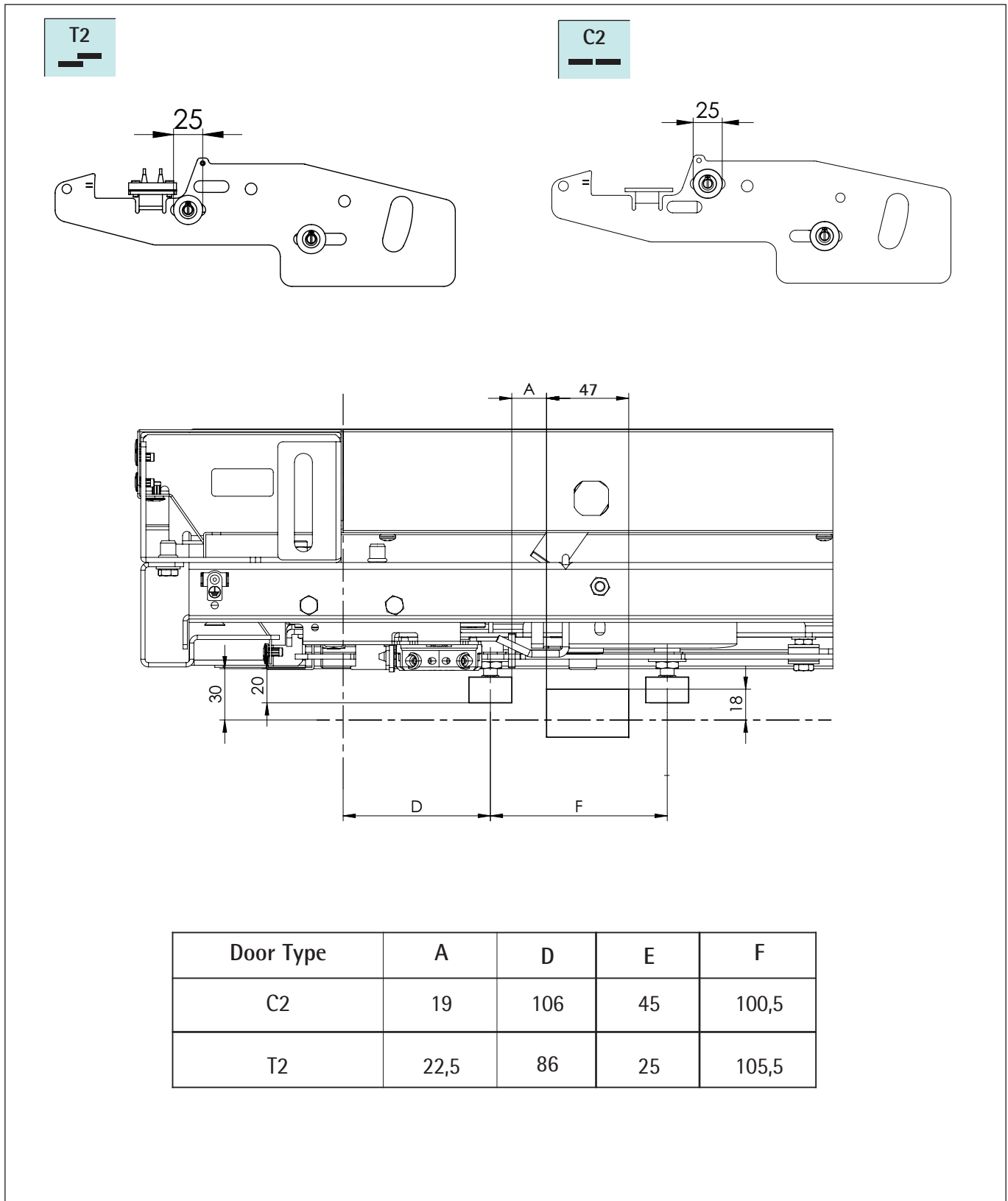

5. ADJUSTMENT OF DOOR PANEL RUNNING CLEARANCE

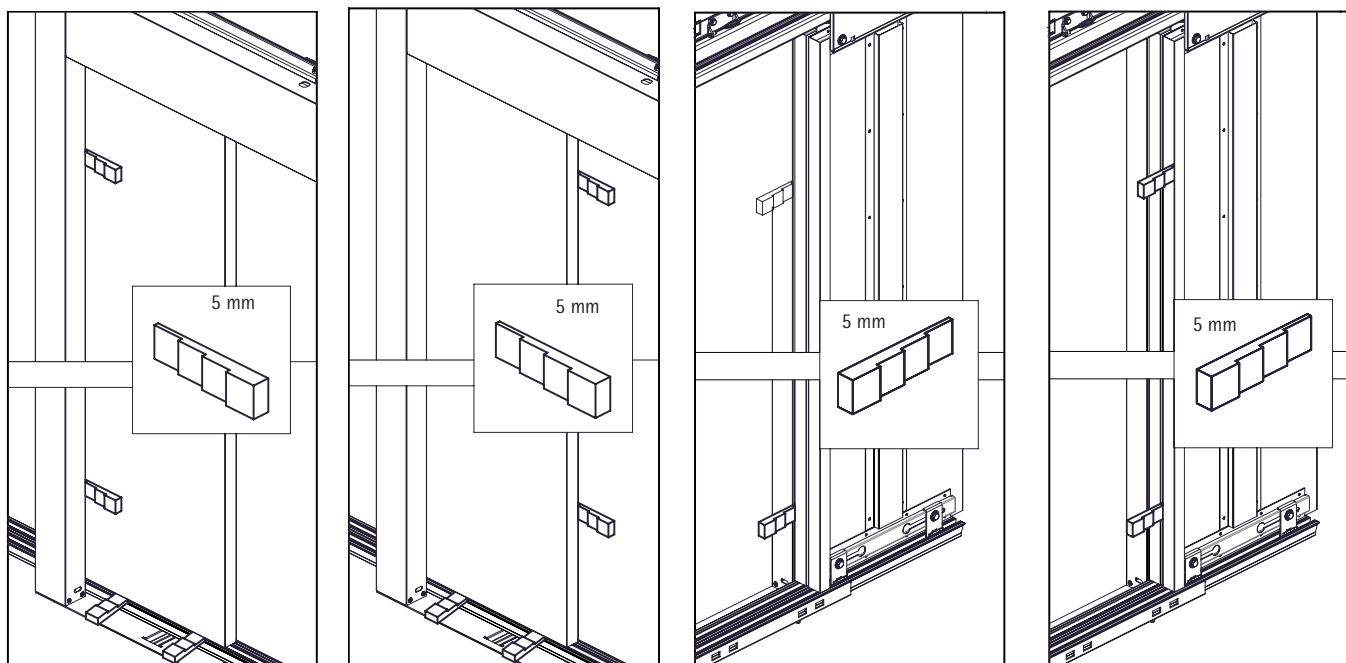

Step	Action	Note
1	Close the door.	Hangers in closed position.
2	Check that the gap between panels or side post is 3-6 mm and even.	
3	Open the door.	Hangers in open position.
4	Check that the gap between panels or side post is 3-6 mm and even.	Adjust the panel front top fixing and/or front bottom guide.

6. ALIGNMENT OF DOOR PANELS

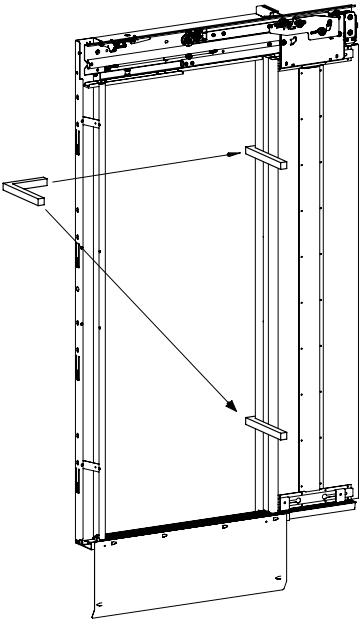
Step	Action	Note
1	<p>Open the door.</p> <p>Adjust the door panel horizontally against side post or door panel.</p> <p>- Adjust rear or front shim package.</p>	<p>Hangers in open position.</p> 

7. TRANSMISSION CABLE

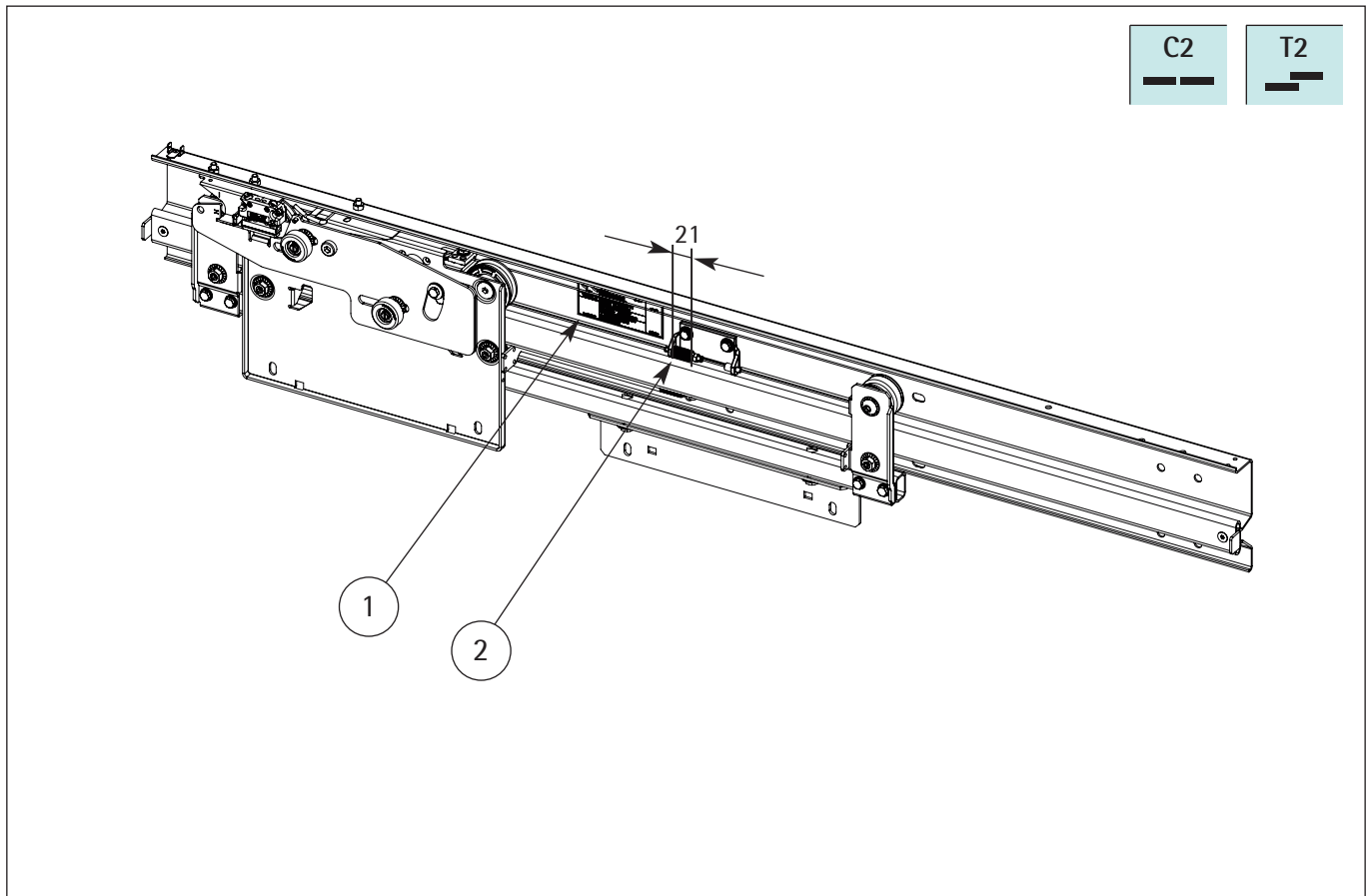

Step	Action	Note
1	The transmission cable is pretensioned by a spring.	Only when replacing the cable (1) make sure that the spring (2) length is 21 mm.

8. CHECK DOOR UNLOCKING DEVICE

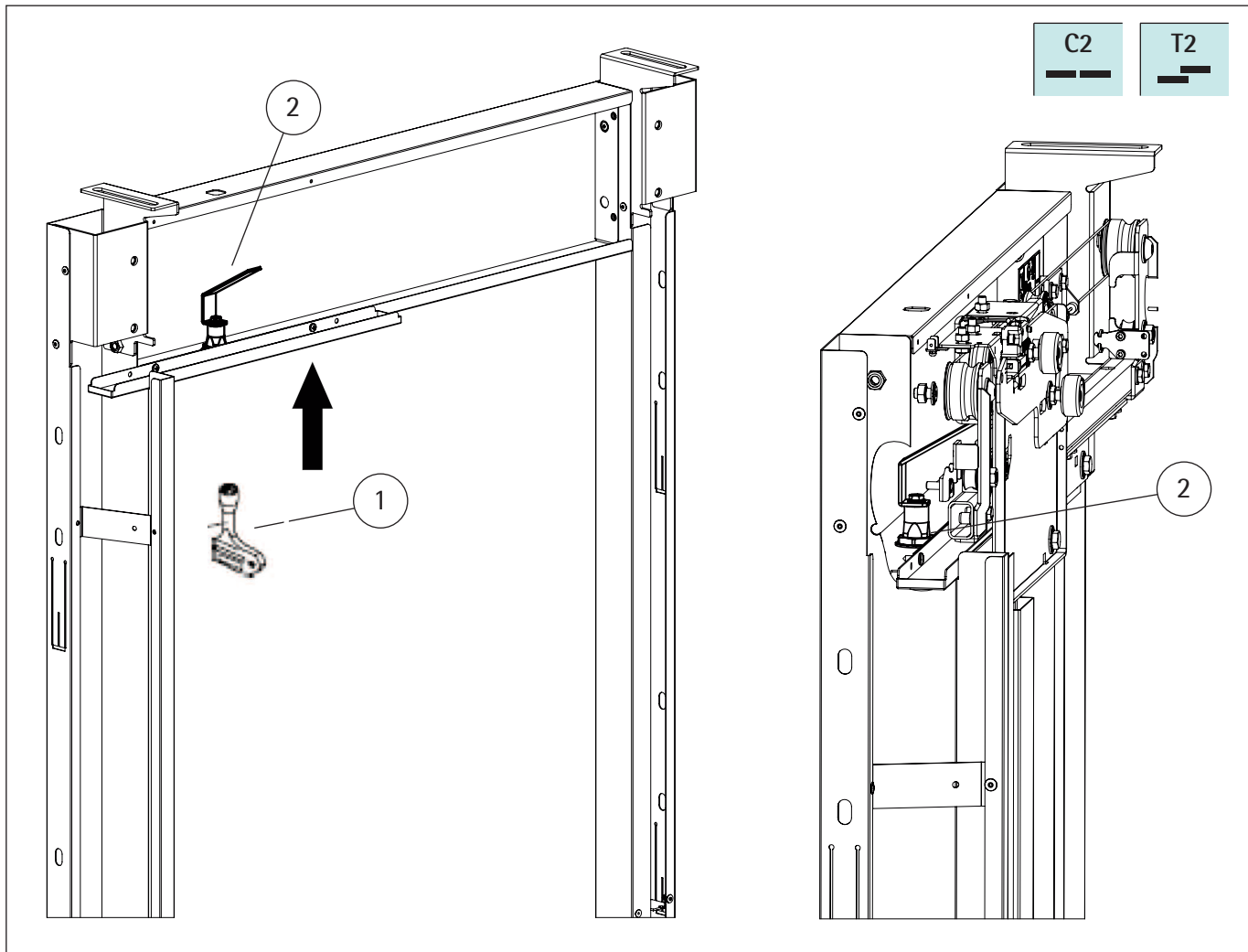

Step	Action	Note
1	Engage the door unlocking device (2) and check its function using the unlocking key (1). In case of KNET, verify that it's not possible to open the lock before the activation of the contact.	Unlocking device without adjustments.

9. LUBRICATION

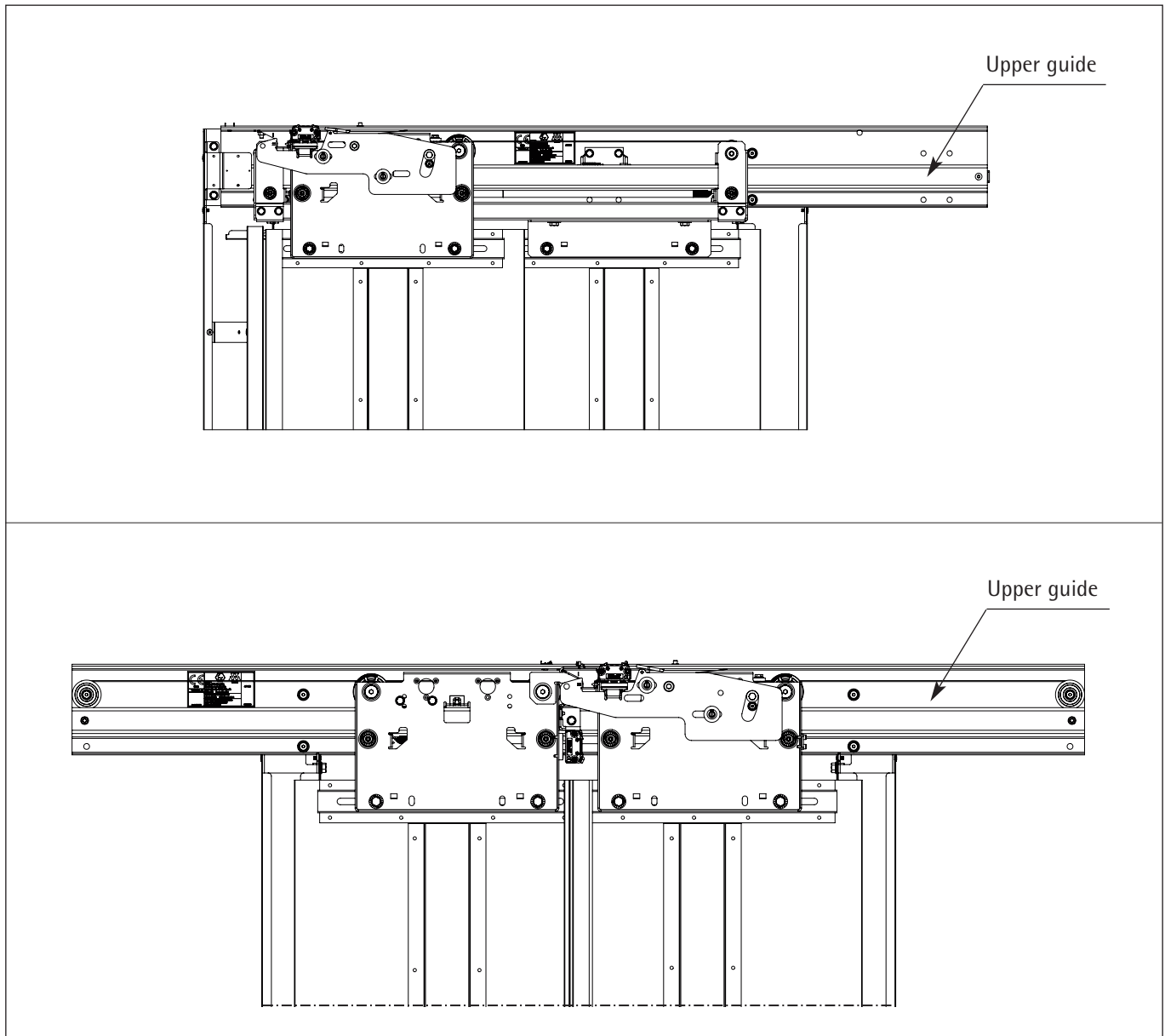

Step	Action	Note
1	Do not grease the upper guides.	Augusta doors are designed with no need of lubrication. It is important to keep clean the mechanism.
2	Do not grease the roller bearings.	

10. MECHANICAL STRENGTH

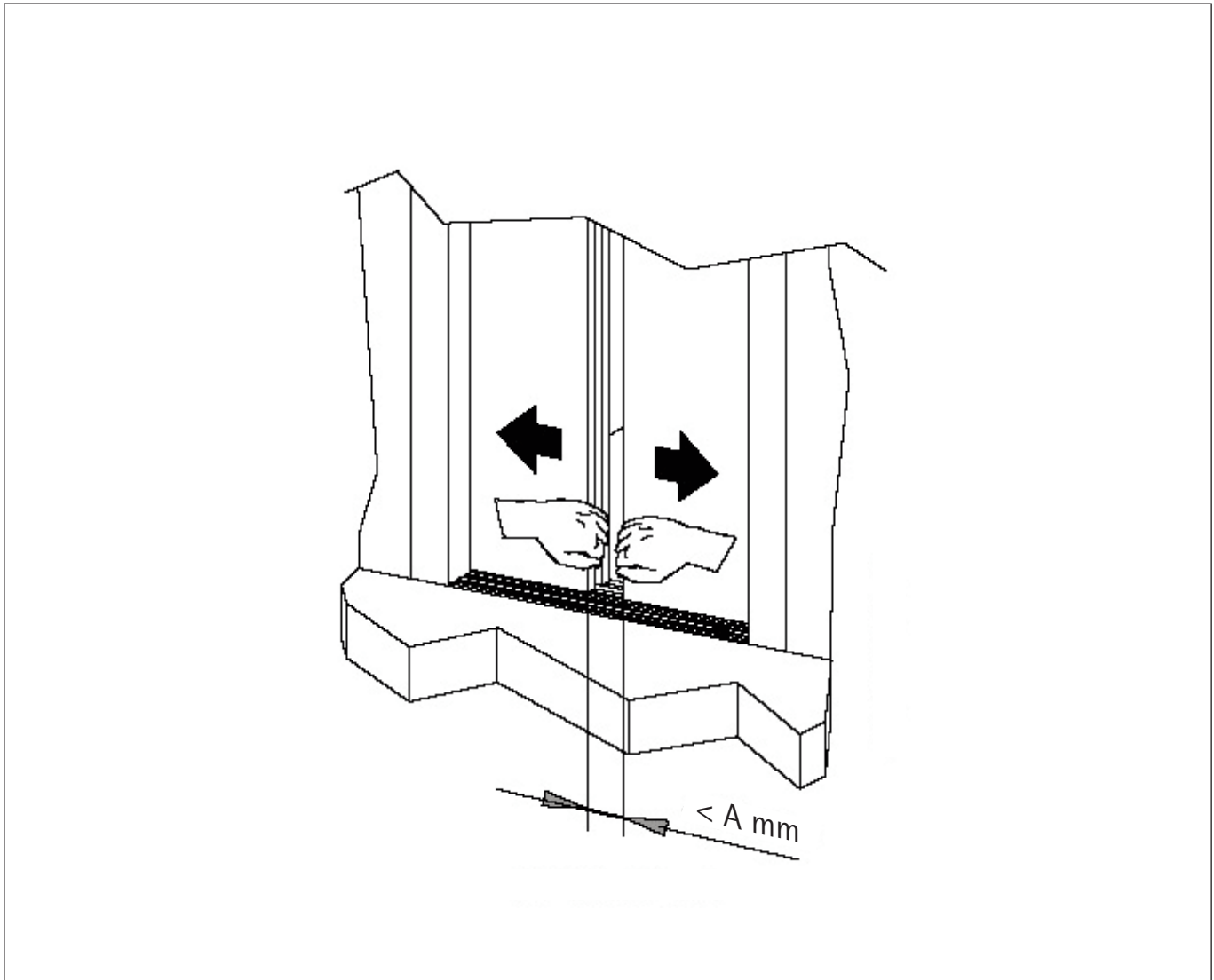

Step	Action	Note
1	Close (lock) the door.	
2	To apply a manual force of 150N in the direction of the opening of the leading door panels.	The measured values (A for EN81-20/50) shall not exceed: - 30 mm For side opening doors - 45 mm In total for centre opening doors
3	If the maximum tolerance has been reached check the door panels adjustment and condition of counter roller below main track.	

11. REPLACEMENT

11.1. Door Panel

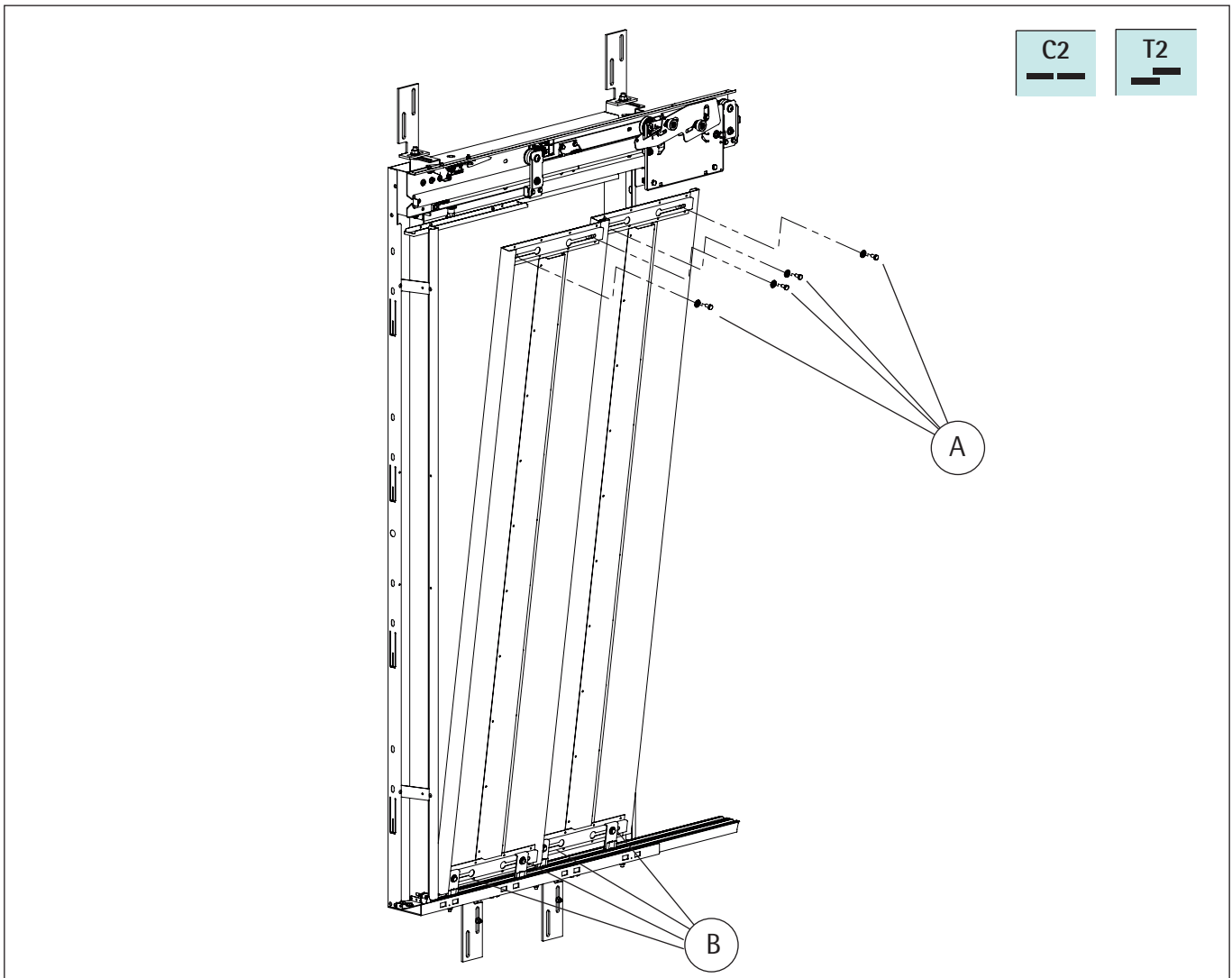

Step	Action
1	Close the door.
2	Remove guide shoes B (See page 25)
3	Loosen the screws (A).
4	Open the door.
5	Remove landing door panels.

11.2. Main rollers

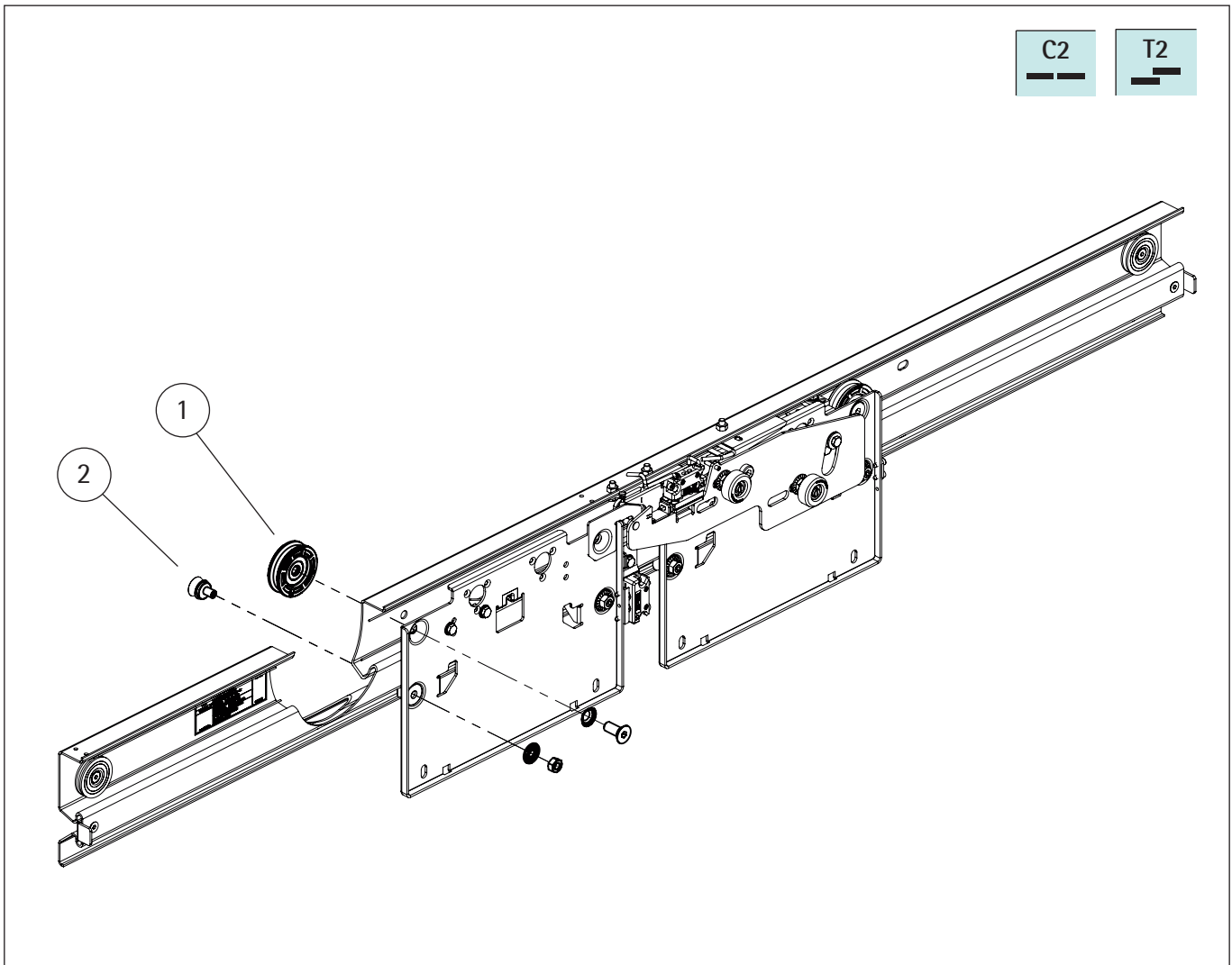

Step	Action	Note
1	Disassembly old main rollers.	a) Untight fixation nut of counter roller. b) Untight counter roller (2). c) Remove fixation screw of main roller. d) Remove old main roller (1).
2	Assembly new main rollers.	a) Mount new main roller (1) and tighten fixation screws. b) Adjust counter roller (see 2.3). c) Tighten fixation nut of counter roller. d) Adjust panel (see 5 and 6). e) Check movement of the door.

11.3. Counter rollers

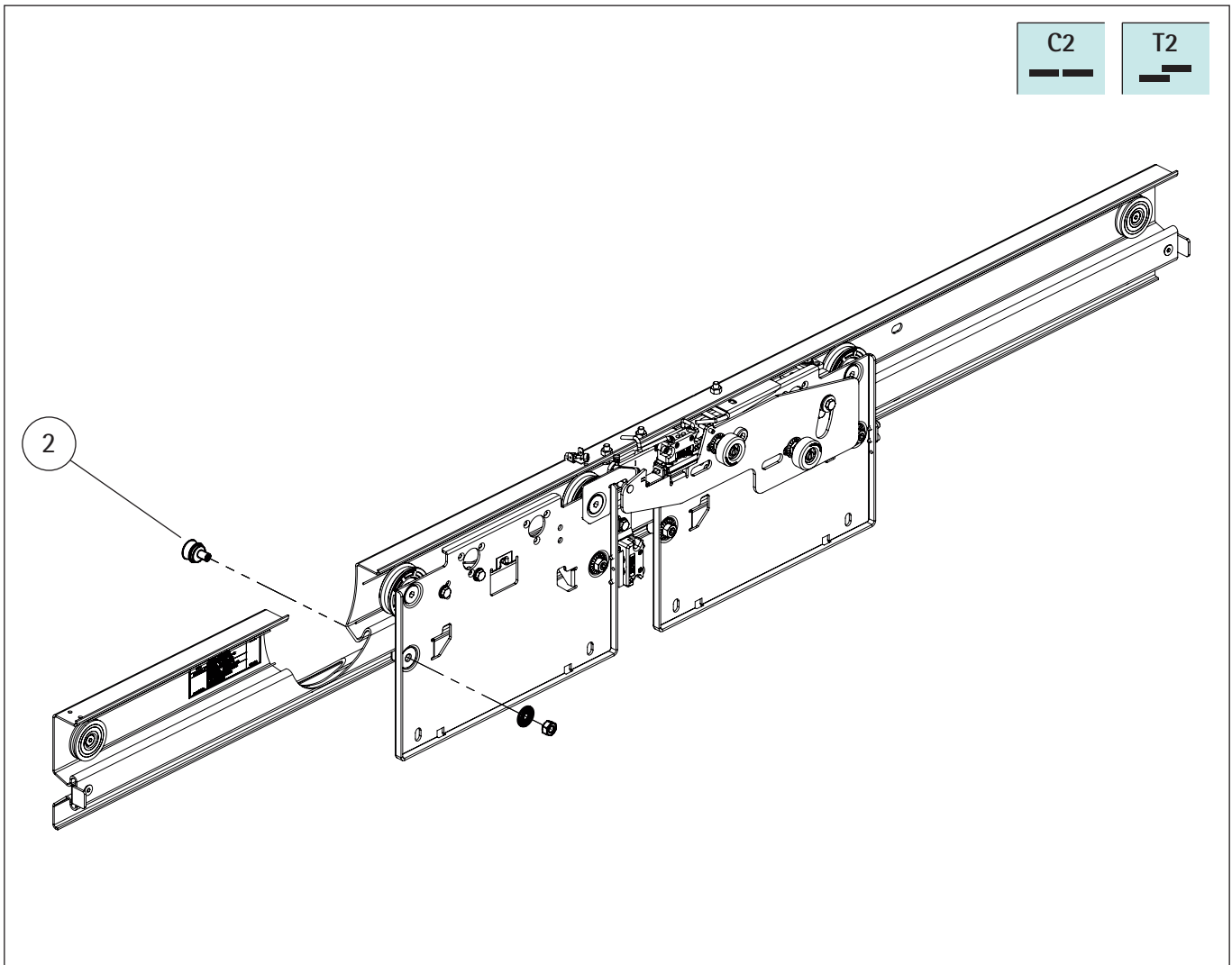

Step	Action	Note
1	Disassembly old counter rollers.	a) Remove fixation nut of counter roller (2). b) Remove old counter roller (2).
2	Assembly new counter rollers.	a) Mount new counter roller (2) and remount nut without fixing. b) Adjust counter roller (see 2.3). c) Tighten fixation nut of counter roller. d) Check movement of the door.

11.4. Door buffer rubber

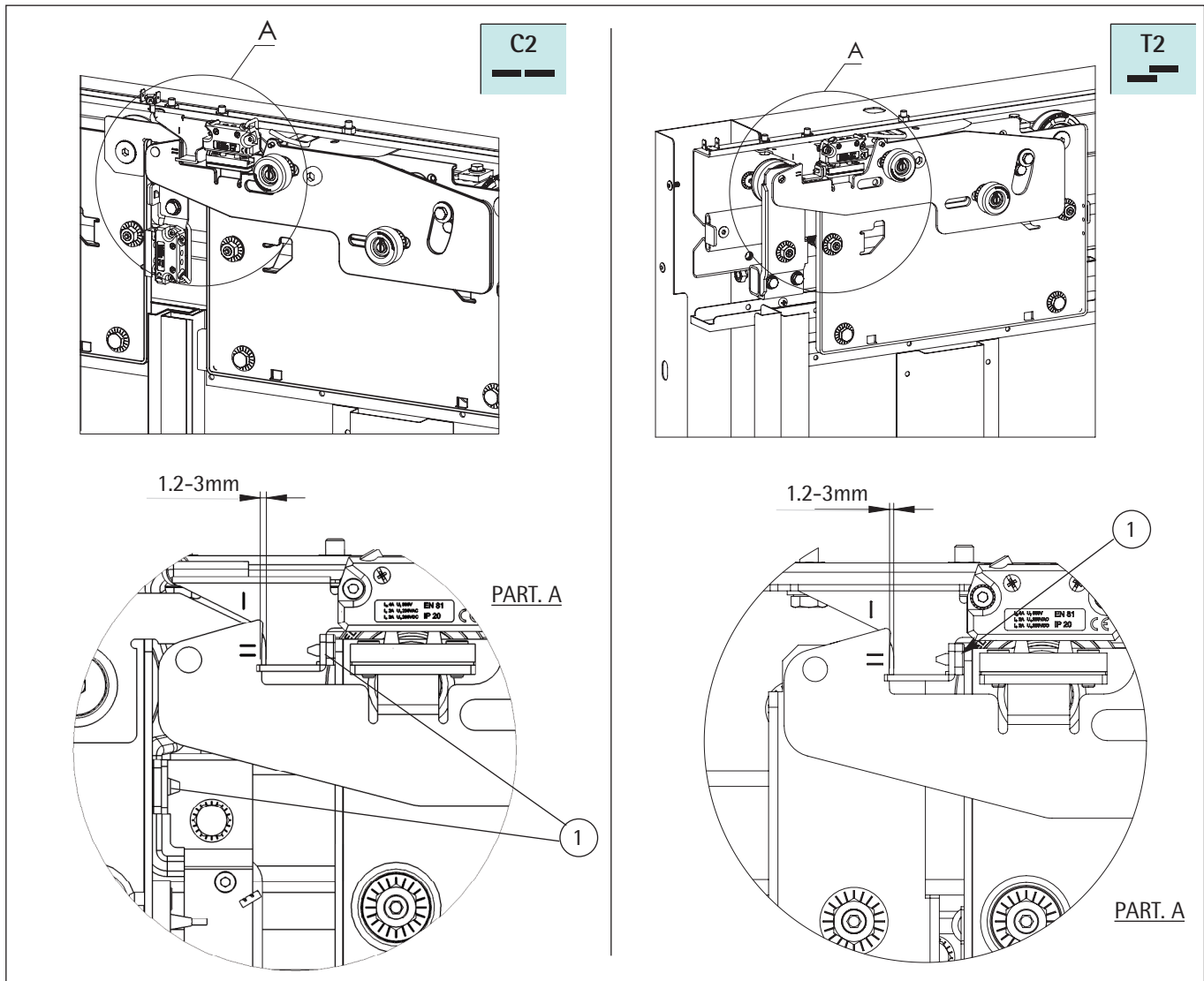

Step	Action	Note
1	Disassembly door buffer rubber.	Remove the old door buffer rubber (1).
2	Assembly door buffer rubber.	Mount the new door buffer rubber (1) with only finger pressure.

11.5. Rubber limit lock

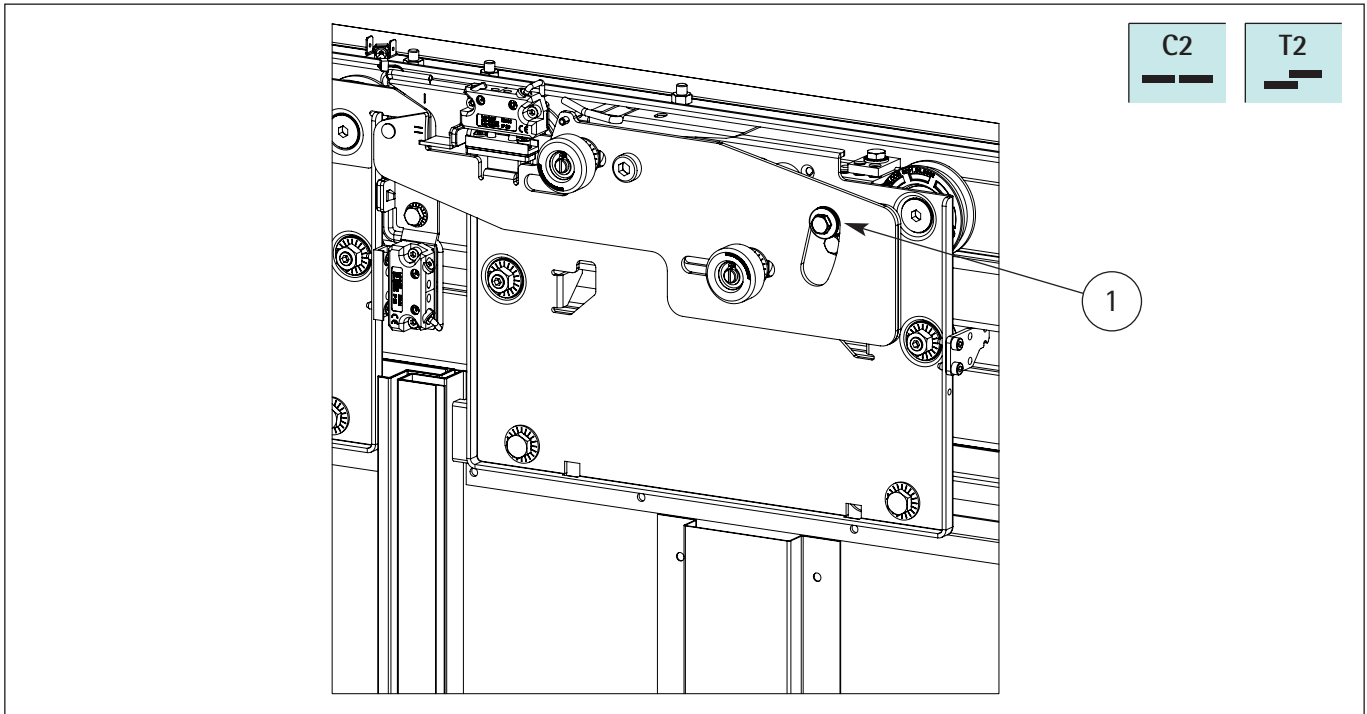

Step	Action	Note
1	Disassembly rubber limit lock.	Remove fixation screw of old rubber limit lock (1).
2	Assembly rubber limit lock.	Tighten fixation screw of new rubber limit lock (1).

11.6. Replace lock rollers

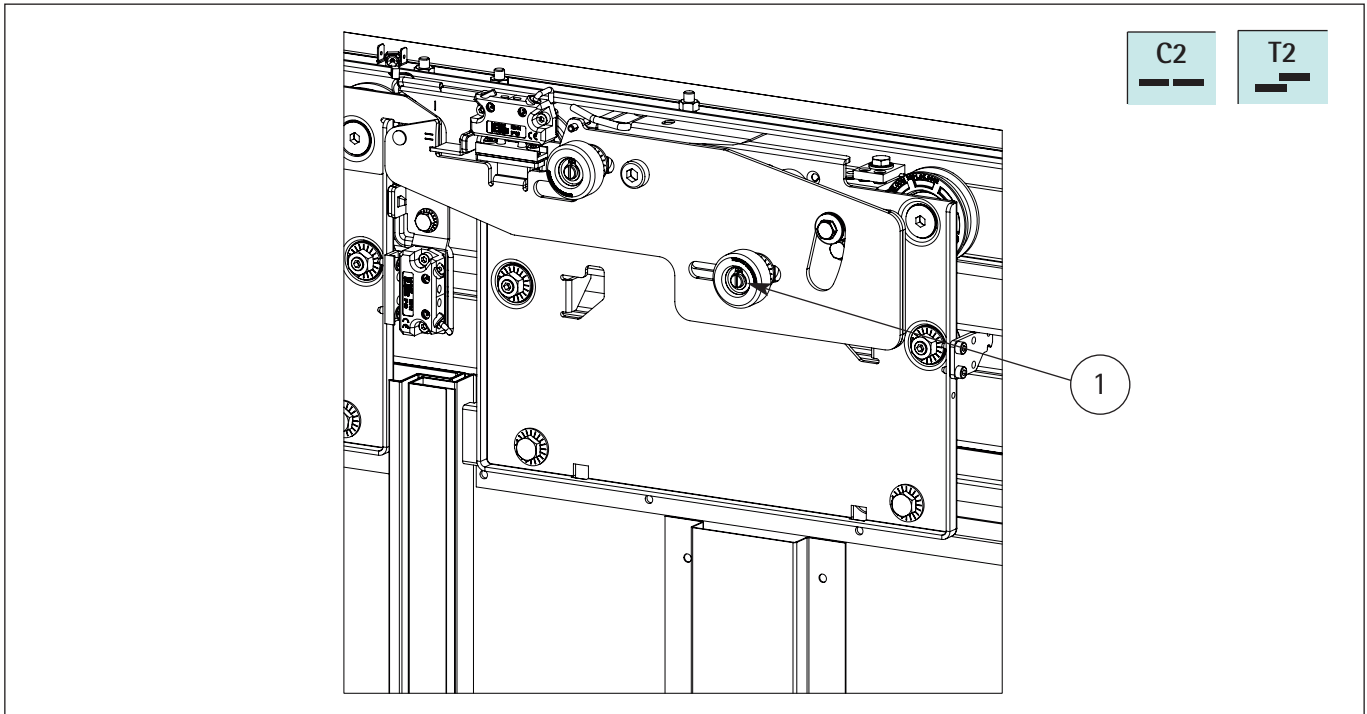

Step	Action	Note
1	Disassembly lock rollers.	Remove fixation seeger of old lock roller (1).
2	Assembly lock rollers.	Mount fixation seeger of new lock roller (1).

11.7. Guide shoes (Check - Replace)

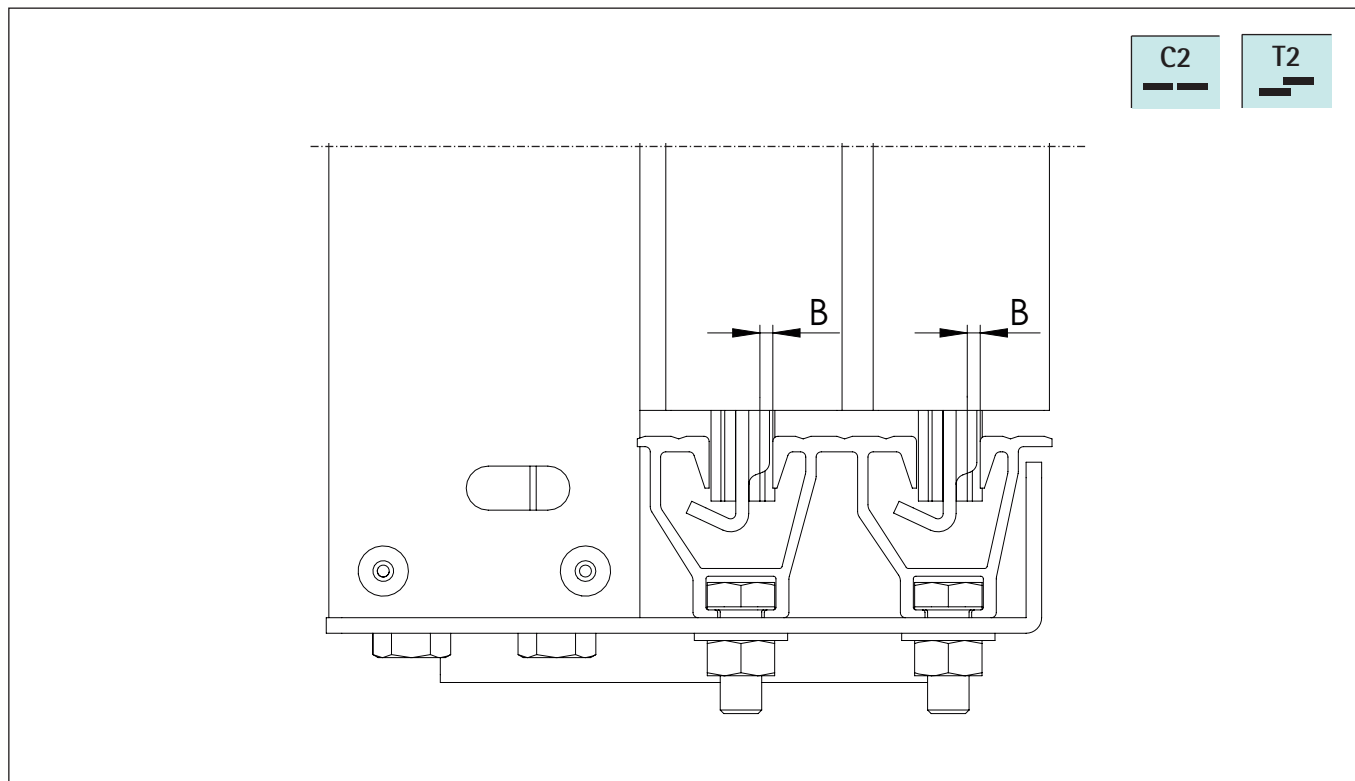

Step	Action	Note
1	Check gap at the sill.	If the gap "B" > 3 mm replace the guide shoe (see Fig. A).
2	Disassembly guide shoes without remove landing door panels. See figures on next page.	a) Unthigh the fixation screws. b) Slide the guide shoe set. c) Push up the plastic shoe (3) using a small screwdriver through the small slot. d) Twist the metallic shoe support (8) and remove it.
3	Assembly guide shoes to the landing door panels.	e) Put the new plastic shoe (3) on the metallic support (2). f) Put the guide shoe set on the sill slot, twisting it. g) Move down the plastic shoe (3). h) Thigh the fixation screws (1). i) Check the movement of the door.

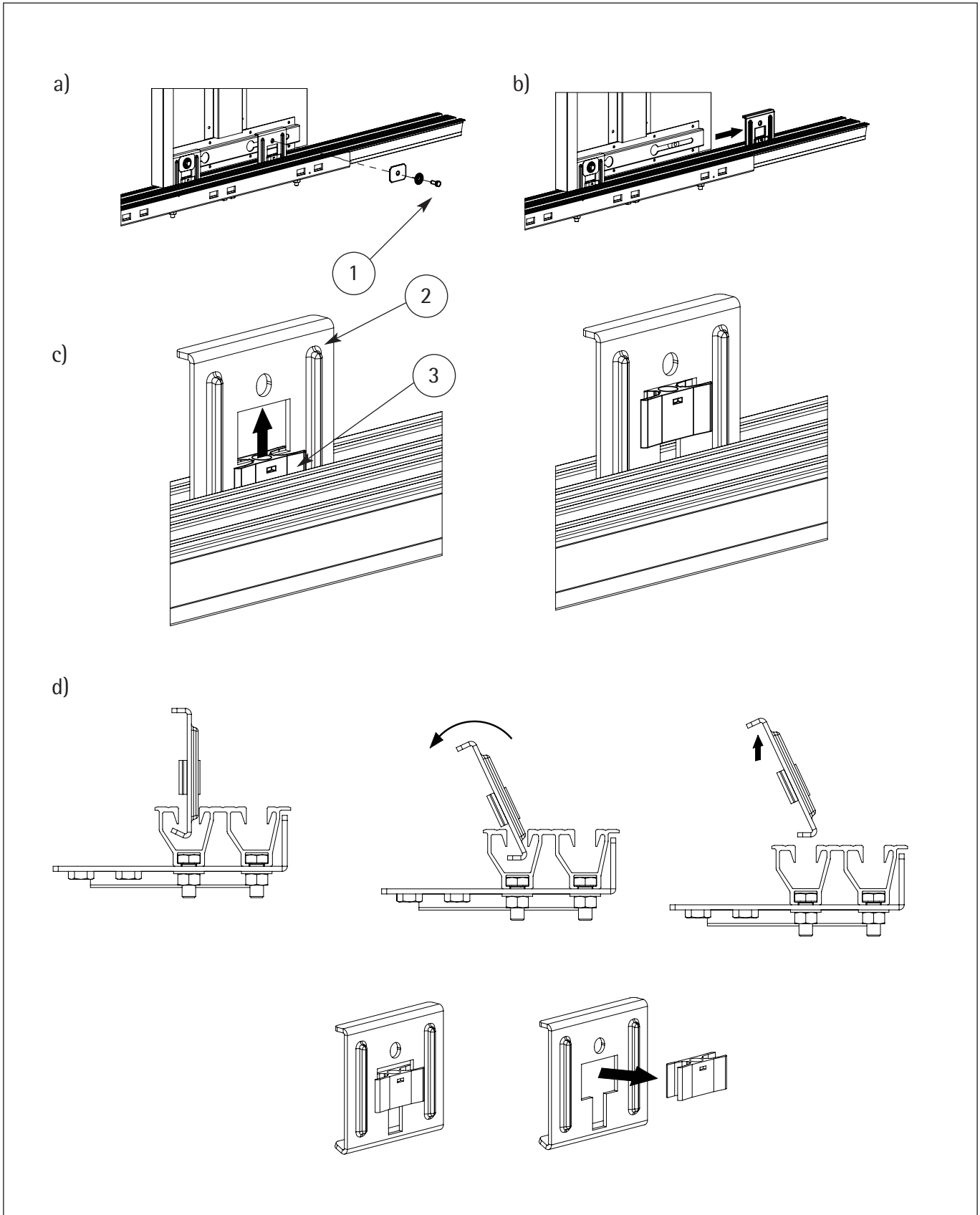

WARNINGS ON HOW TO KEEP THE DOORS IN GOOD OPERATING CONDITIONS



In order to prevent failures or incorrect operation and to maintain the system in good conditions, the technical condition of the system should periodically be checked, to ensure compliance with the applicable laws.

The technical condition depends on various factors such as:

- Work load
- Years of operation
- Door weight
- Climatic and environmental conditions
- Cleanness of environment
- Correct maintenance
- Etc.

And it can affect:

- Clearance/interference between the doors, and between the doors and posts according to the applicable laws
- Clearance of coupling device
- Status/conditions of fixing and coupling elements
- Conditions of parts affected by wear
- Operation of the lock and relevant contacts
- Any other parts that may be affected by the type of application.

For these reasons it is not possible to establish a general part replacement programme beforehand.